

# Downtown

Tables

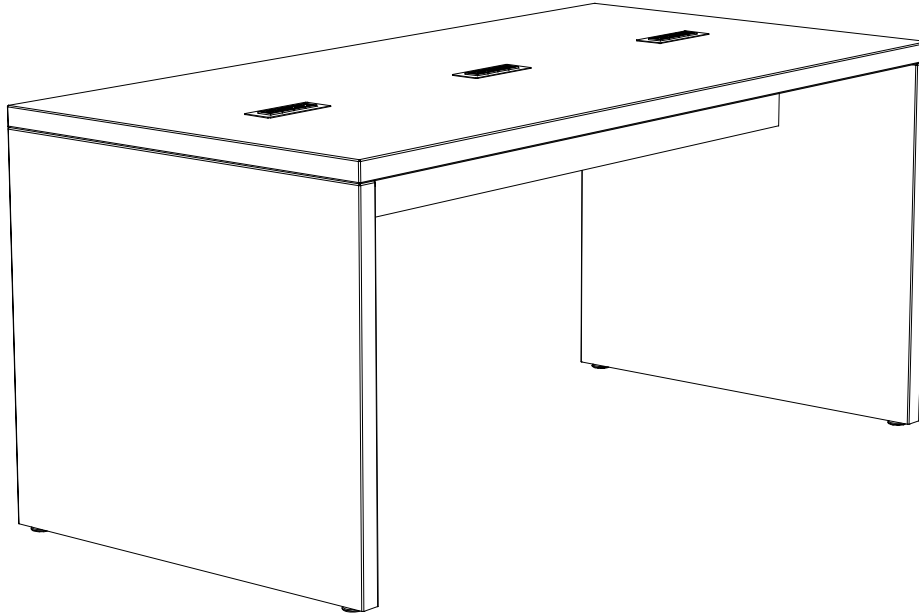

## Hardware Included:

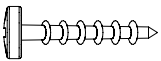

#8 x 5/8"  
Pan Head Screw

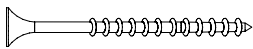

#8 x 1-1/2"  
Flat Head Screw

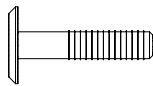

1/4-20 X 15mm  
Connector Bolt



#12 x 1"  
Pan Head Screw

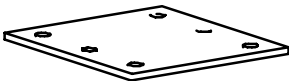

3" x 3"  
Mending Plate

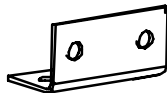

1" x 1" x 2"  
L-Bracket

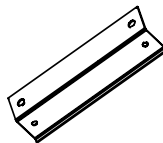

7" Z-Bracket

## Tools Required:

- Phillips Head Screwdriver
- Flathead Screwdriver
- Allen Wrench

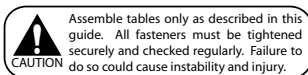

# Downtown

Tables

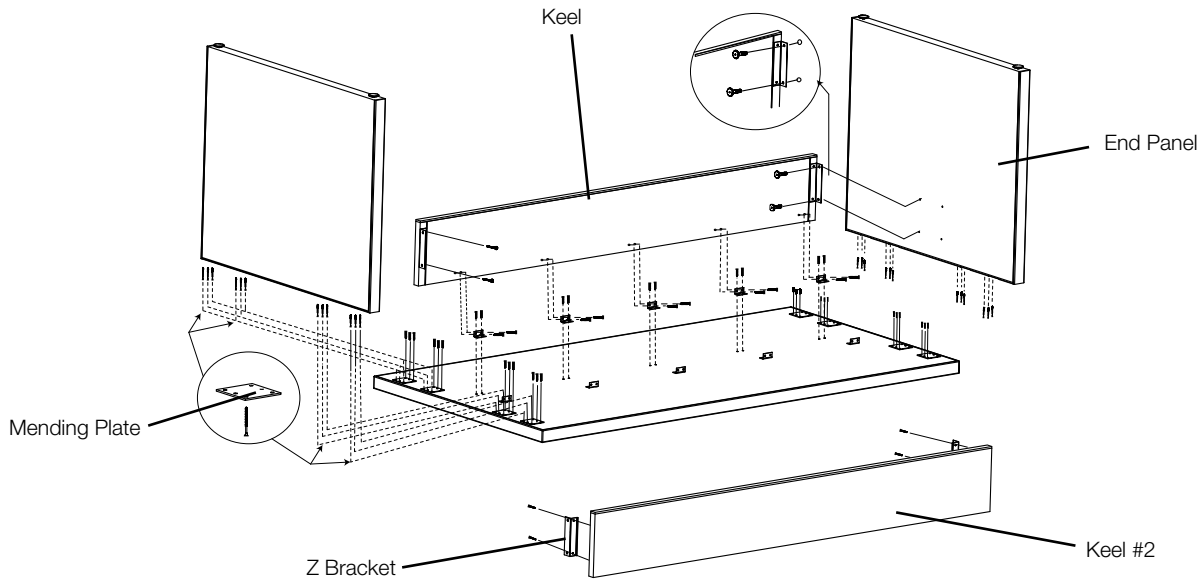

**Step 1:** Attach (4) 3" x 3" mending plates to the top edge of each end panel using #8 x 1-1/3" Flat Head Screws.

**Step 2:** Attach (5) 1" x 1" x 2" L-brackets to the dadoed side of each stretcher using #8 x 5/8" Pan Head Screws.

**Step 3:** Place table top with laminate side down on a protective surface.

**Step 4:** Loosely attach z-brackets to the end panels with the 1/4-20 x 15mm Connector Bolts.

**Step 5:** Set the stretchers in place so the lip of the z-bracket fits into the dado on both ends of the stretcher, then attach to the stretcher with #12 x 1" Pan Head Screws.

**Step 6:** Now go back and tighten Connector Bolts on the end panels.

**Step 7:** Center the assembled base on the table top; attach it to the top with the small L-brackets and #8 x 5/8" Pan Head Screws as shown. Attach mending plates to top using #12 x 1" Pan Head Screws

**Optional:** Attach cable management channel to stretchers with screws provided.

**Step 8:** Flip the table over and adjust the glides as needed to make the table level.

instructions-downtown-230214

