

Porter Table

Base Assembly

Tables

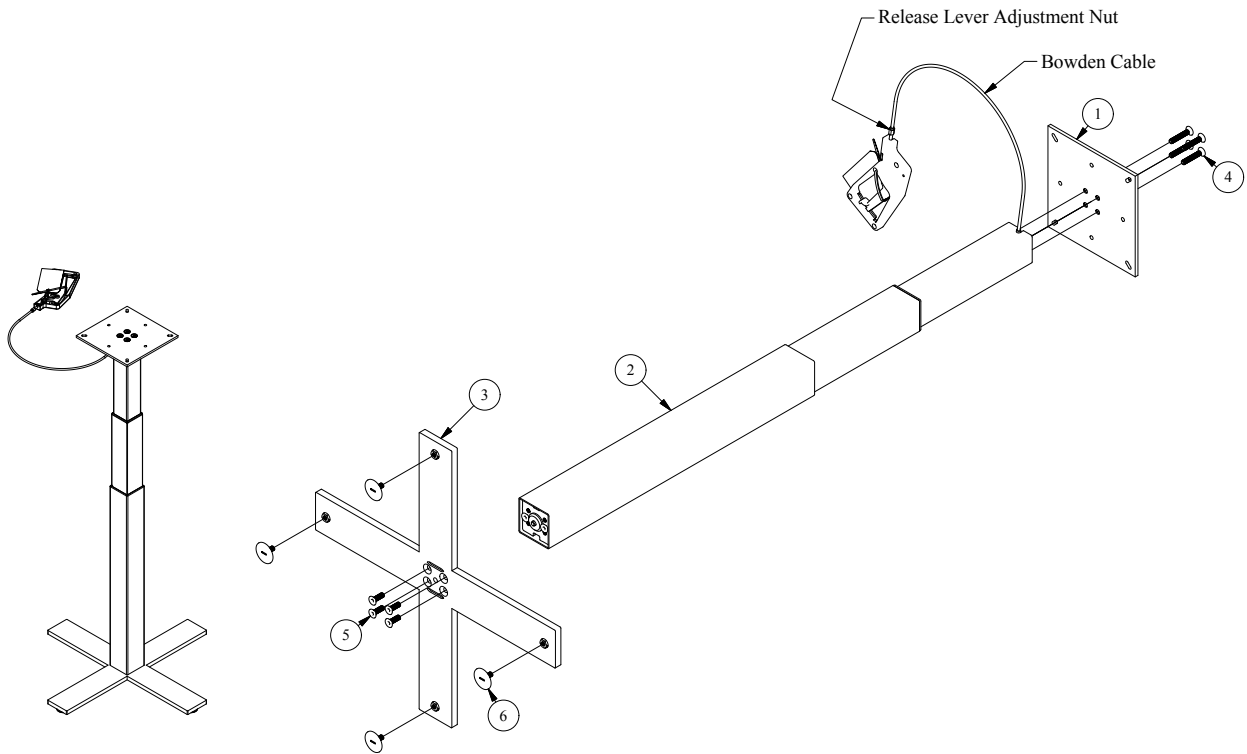

Hardware Included:



M8 x 45mm

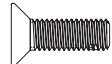

M8 x 25mm



Leveler

Tools Required:

- 5mm Hex Drive

Assembling the Table Base

Step 1: Align the four holes in the Mounting Plate (#1) with the four tapped holes in the Column (#2). Insert the M8 x 45mm Screws (#4) thru the Mounting Plate and thread into the Column. With a 5mm Hex Drive, tighten the screws to 15 pounds of force.

Step 2: Align the four (4) holes in the X-Base (#3) with the four tapped holes in the Column as shown. Insert the M8 x 25mm Screws (#5) thru the X-Base and thread into the Column. With a 5mm Hex Drive, tighten the screws to 15 pounds of force.

Step 3: If not pre-installed, turn the threaded end of the Levelers (#6) or casters into the threaded inserts on the bottom side of the X-Base.

Step 4: Turn the Release Lever Adjustment Nut until there is a small amount of play in the handle lever.

***Note: when attaching the handle to the table top, place such that the cable does not kink.*

Porter Table

Worksurface Assembly

Tables

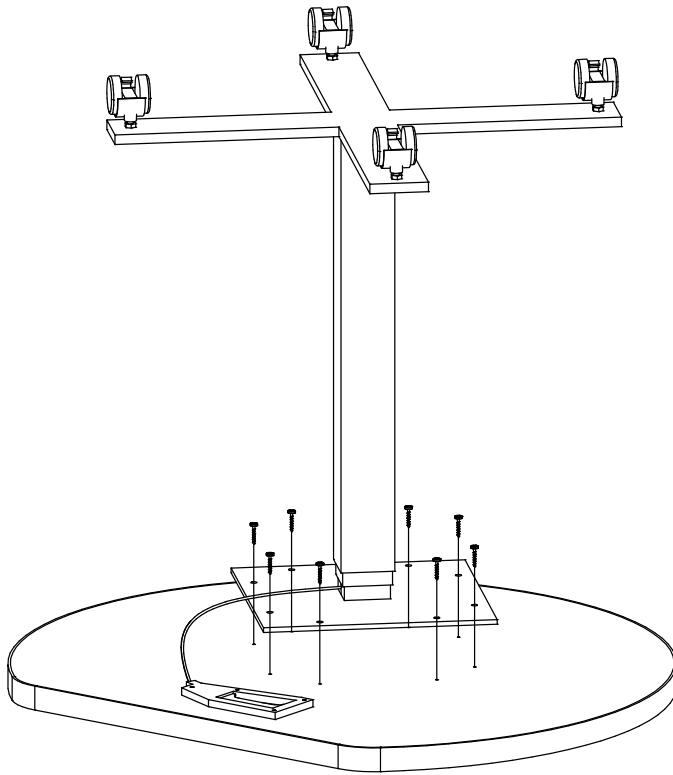

Hardware Included:

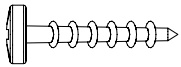

#12 x 1" PH Screws

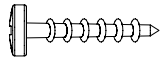

#8 x 3/4" PH Screws

Tools Required:

- #2 Phillips Head Screwdriver

Assembling the Worksurface

Step 1: Assemble table base. (Page 1 of Porter Table Assembly Guide)

Step 2: Place Table Top down on a clean and padded surface. Attach Base Assembly to table top using (8) #12 x 1" PH Screws.

Step 3: Fasten handle to Table Top using (4) #8 x 3/4" PH Screws. ** *Verify cable isn't kinked.*