

ATLAS STAND

Display

General Specifications

The sloped top is 1-1/4" thick three ply engineered wood with a .050" thick laminate top with 1/8" solid red oak edge bands. The cabinet is constructed of 1-3/16" engineered wood with select red oak faces. All exposed edges are banded with 1/8" solid red oak. The unit has five adjustable 3/4" thick pull out shelves with a 1-1/2" solid oak front retainer. Juvenile height is 34" with 4 pull out shelves.

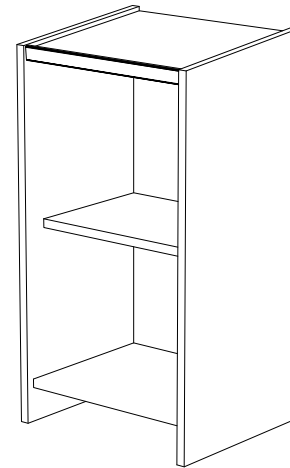

Atlas Stand				
Lines	Model Number	Description	Wgt.	List Price
Bookmark	B2424AS	24" D X 24" W X 45" H	150	\$3,518
Bookmark Juvenile	B2424AS-J	24" D X 24" W X 34" H	146	\$3,417
*Charleston	CL2424AS	24" D X 24" W X 45" H	150	\$5,655
*Heritage	H2424AS	24" D X 24" W X 45" H	150	\$5,268
*Lexington	L2424AS	24" D X 24" W X 45" H	150	\$5,655
*Malibu	MB2424AS	24" D X 24" W X 45" H	150	\$5,651
*Metro	M2424AS	24" D X 24" W X 45" H	152	\$3,783
*Twist	TW2424AS	24" D X 24" W X 45" H	152	\$3,897

Designer Lines* versions.

Required to order: Model # including options if applicable

- HPL Selection
- Wood finish selection

Note: Prices for items with wood veneer or edges is based on oak. Use of maple or other species may incur an upcharge .

Set Up Charges and Upcharges for Non-Standard and Custom Finishes		
Model Number	Description	List Price
Custom Finish	Upcharge for custom stain finish	\$640
Non-Standard Stain	Upcharge for non-standard stains already matched	\$283
Sprayon Finish	Upcharge, per color, per order, for Sprayon finish	\$329